

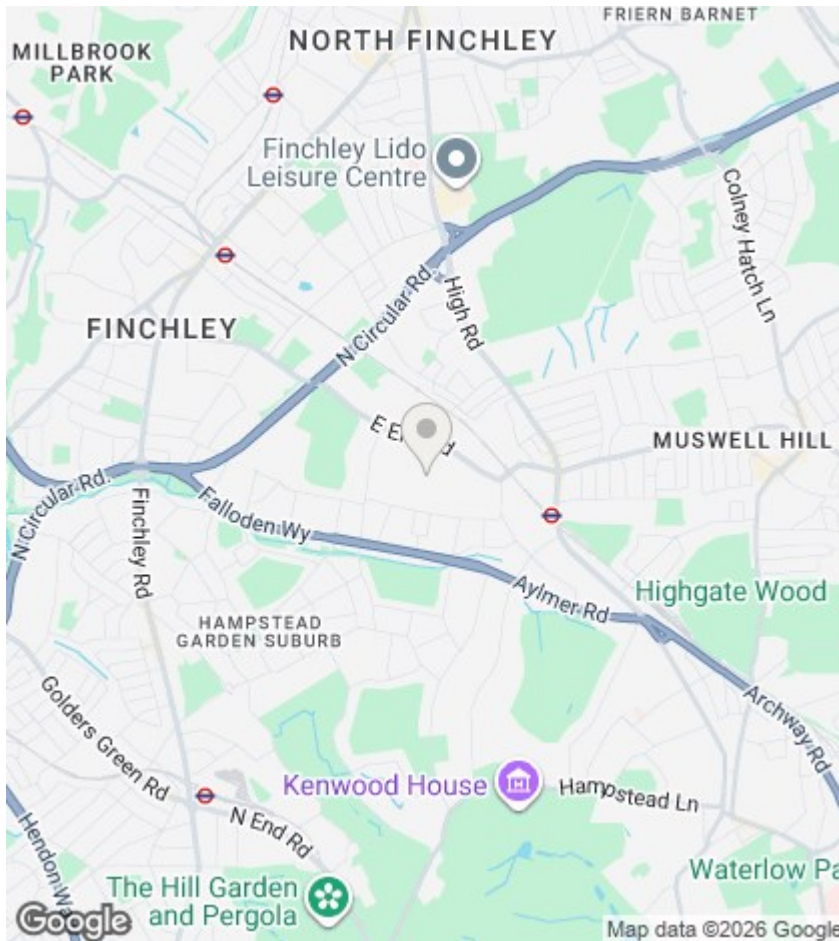

Elmshurst Crescent, London, N2 0LP

£450,000

- Balcony
- Gas Central Heating
- New Lease Upon Completion
- Double Glazed Windows
- Communal gardens
- Ideal Rental Investment or First Time Buy
- Three Bedrooms
- Service Charge Approximately £1,917 pa



Directions

Viewings

Viewings by arrangement only. Call 020 8444 5222 to make an appointment.

Council Tax Band:

EPC Rating:

C

Energy Efficiency Rating		
	Current	Potential
Very energy efficient - lower running costs		
(92 plus) A		
(81-91) B		
(69-80) C	69	75
(55-68) D		
(39-54) E		
(21-38) F		
(1-20) G		
Not energy efficient - higher running costs		
England & Wales		
EU Directive 2002/91/EC		

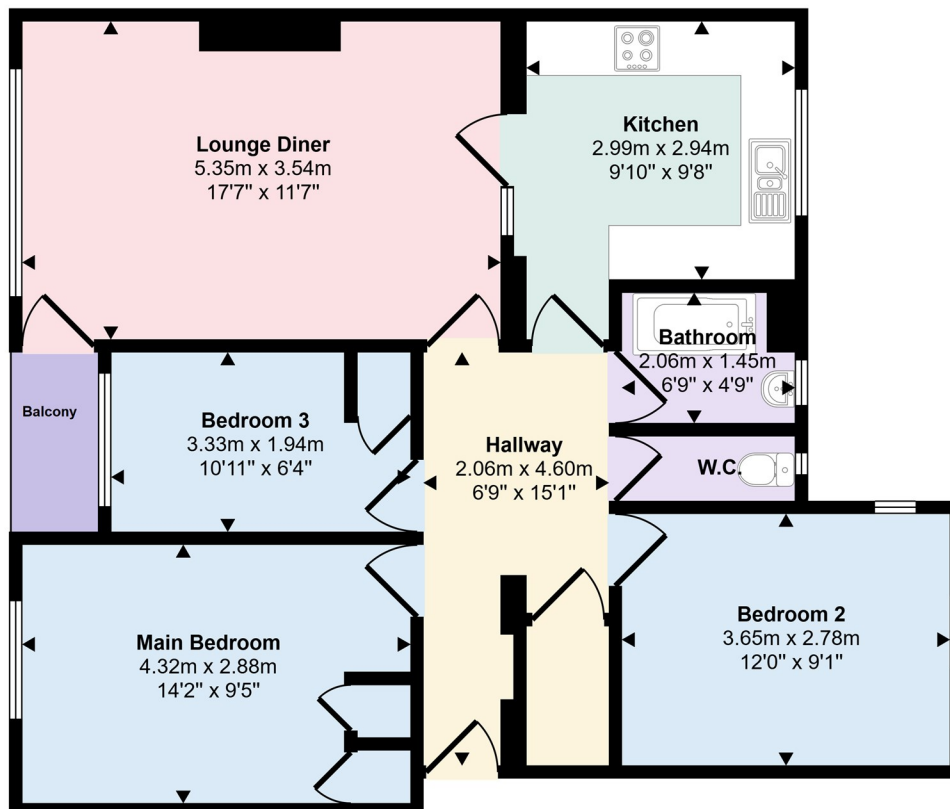

Floorplan